

# Man50 In-line Centrifugal Fan Range

MAN50/MAN50SF/MAN50SLK



- Providing solutions for a wide range of domestic and commercial applications, the MAN50 in-line fan has been designed for use with suspended ceilings. A spring operated, non-return flap is built into the discharge spigot to prevent backdraughts.
- Powerful, yet quiet and unobtrusive, the MAN50 units have extract rates of 110m<sup>3</sup>/hr 31 litres per second.
- The MAN series is suitable for a wide range of applications including bathrooms, toilets, shower rooms and utility rooms.
- The MAN series is fitted with backward curved centrifugal impellers for a large airflow against the high pressures caused by longer lengths of ducting and resistance by grilles.
- There is an extensive range of ventilation accessories available to cover most in-line ducting systems.
- The MAN50 units are manufactured using high impact ABS thermoplastics for strength and durability, aesthetics and easy cleaning.
- Available with an integral mounting bracket. Designed to comply with the 2006 Building Regulations on Ventilation (F1).
- The MAN50 range is powered by a single phase induction motor with pre-oiled bearings for a long, maintenance-free life.



- The MAN50 Shower Kit comprises of the MAN50 centrifugal in-line fan unit, 6 metres of PVC ducting and wall grilles.
- The MAN50 Showerlite Kit which comprises of the MAN50 centrifugal in-line fan unit, 6 metres of PVC ducting and wall grilles together with a chrome Showerlite fitting and transformer.

## Technical Details

Cat. No.	Product type
<b>MAN50S</b>	Standard model with bracket
<b>MAN50T</b>	Timer model with bracket
<b>MAN50TSFK</b>	Timer model in-line fan kit (100mmØ)
<b>MAN50TSLKC</b>	Timer model in-line Showerlite fan kit (100mmØ) Chrome

**Packaging**  
MAN50 Series in outers of 5  
For packaging dimensions please contact our technical department.

**Electrical**  
220-240V - AC. 50Hz . Single phase consuming 20W on the MAN50  
All wiring must comply with the current IEE regulations. A double pole isolating switch, having a contact separation of at least 3mm in all poles, must be used with a 3 amp fuse fitted.

**Additional Data**  
MAN50 Maximum pressure 120p.a.  
Fan speed: 1400 r.p.m.  
Sound volume: 45.0dB(A)  
Maximum operating temperature: 40°C

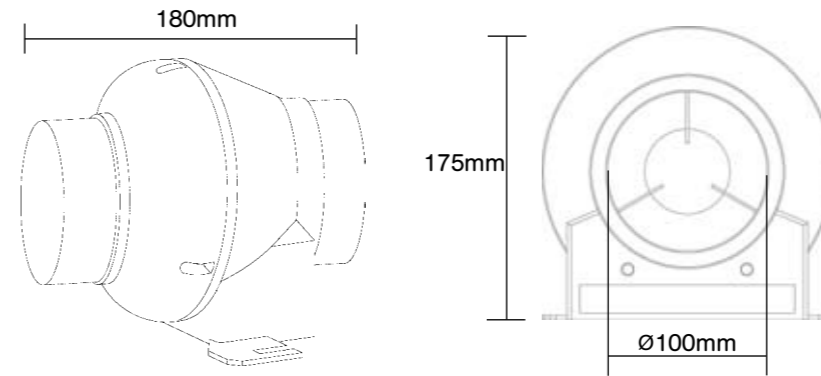

**Performance Graph**  
MAN50 Range 110m<sup>3</sup>/hr, 31 litres per second

